

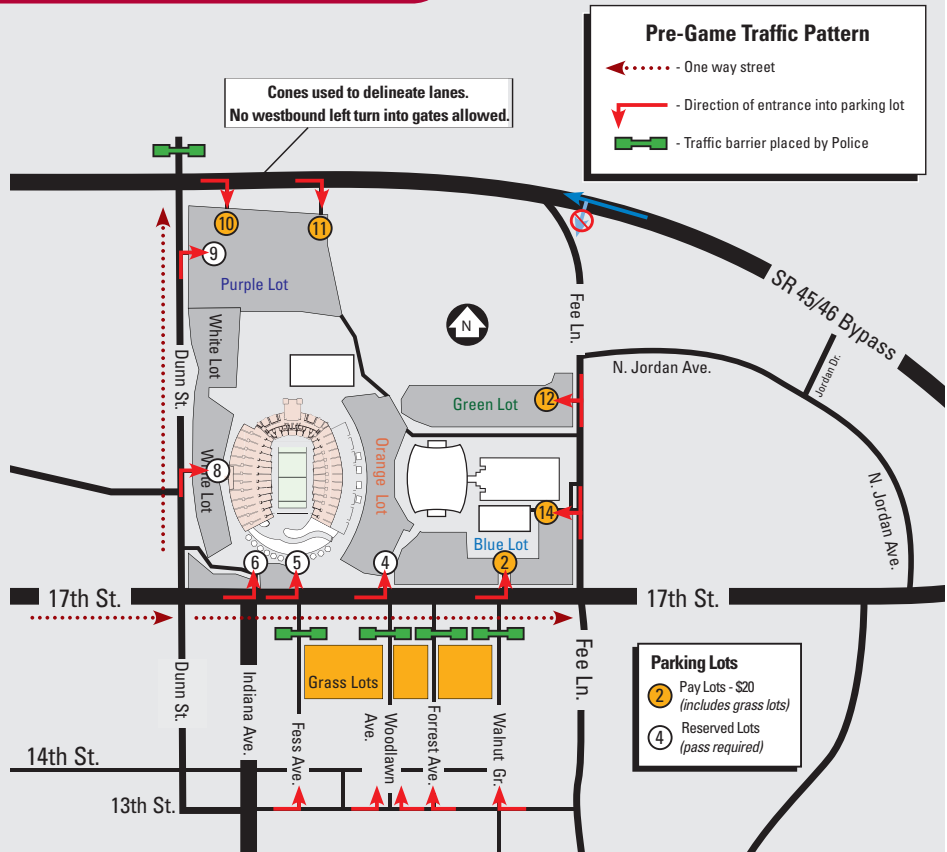

# MEMORIAL STADIUM PRE-GAME TRAFFIC

*Due to the construction schedule on the 45/46 Bypass, this traffic pattern may be modified at the discretion of law enforcement agencies.*

- **Heavy traffic congestion is expected. PLEASE ARRIVE EARLY.**
- **Parking lots open a minimum of 5 hours prior to kickoff each game.**
- **One-way traffic patterns will go into effect a minimum of 2 hours prior to kickoff each game.**
- **The 45/46 Bypass is scheduled to remain two-way to the stadium.** However, westbound traffic will not be allowed to turn southbound onto Fee Lane. Westbound traffic will also be prohibited from entering gates 11 & 10.
- **Coming from the East?** Please refer to Alternative Routes to Memorial Stadium on reverse side for route options to the Athletics Complex from the South.
- **17th Street will be one-way east** from N. College Avenue to Fee Lane (two lanes).
- **Dunn Street will be one-way north** from 17th Street to the 45/46 Bypass (two lanes).



# MEMORIAL STADIUM POST-GAME TRAFFIC

*Due to the construction schedule on the 45/46 Bypass, this traffic pattern may be modified at the discretion of law enforcement agencies.*

- **Please be patient when exiting the Stadium.**
- **Follow instructions provided by law enforcement assisting with post-game traffic.**
- **The 45/46 Bypass will be one-way west** from Fee Lane to Walnut Street .
- **Dunn Street will be one-way south** from the 45/46 Bypass to 17th Street (two lanes).
- **17th Street will be one-way west** from Fee Lane to College Avenue (two lanes).

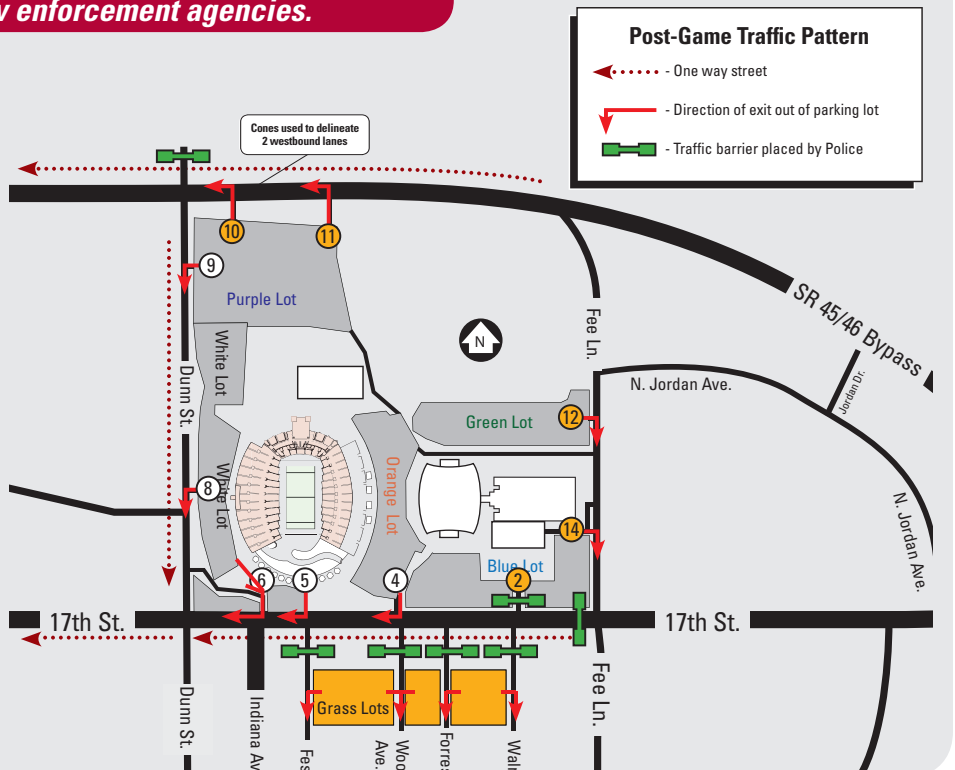

**For more information on traffic routes and parking, go to [www.IUHoosiers.com](http://www.IUHoosiers.com) or follow @iutrafic on Twitter.**